

STATE OF UTAH



OFFICE OF THE LIEUTENANT GOVERNOR

CERTIFICATE

I, GARY R. HERBERT, LIEUTENANT GOVERNOR OF THE STATE OF UTAH, HEREBY CERTIFY THAT there has been filed in my office notices of boundry changes from the TAYLOR WEST WEBER WATER IMPROVEMENT DISTRICT, dated January 28th, 2008, complying with Section 67-1A-6.5, Utah Code Annotated, 1953, as amended.

NOW, THEREFORE, notice is hereby given to all whom it may concern that the attached are true and correct copies of the notices of boundary change, referred to above, on file with the Office of the Lieutenant Governor pertaining to the TAYLOR WEST WEBER WATER IMPROVEMENT DISTRICT, located in Weber County, State of Utah.

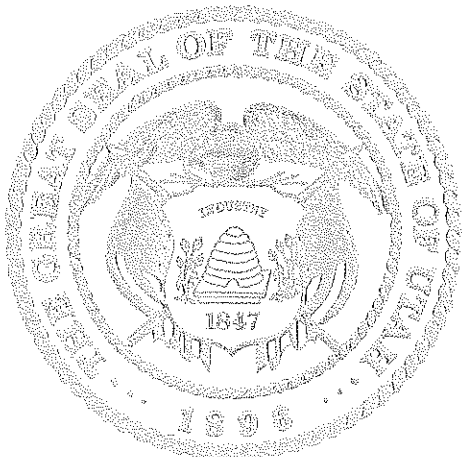

IN TESTIMONY WHEREOF, I have hereunto set my hand, and affixed the Great Seal of the State of Utah this 6th day of May, 2008 at Salt Lake City, Utah.

A handwritten signature in black ink, reading "Gary R. Herbert".

GARY R. HERBERT
Lieutenant Governor



W2330458

EN 2330458 PG 1 OF 8
ERNEST D ROWLEY, WEBER COUNTY RECORDER
26-MAR-08 1137 AM FEE \$.00 DEP SPY
REC FOR: TAYLOR WEST WEBER WATER DIST

**TAYLOR WEST WEBER WATER IMPROVEMENT
DISTRICT
4660 WEST 1150 SOUTH
OGDEN, UTAH 84404**

Narration: This document is intended as a correction to a document of the same format, notarized on January 23rd, 2008, and recorded in the Weber County Recorder's Office on January 28th, 2008 as entry #2318044. Said previous document describes annexation areas numbered 1 through 22. During the process of mapping the previously recorded document, typographical errors were discovered in the legal descriptions recorded on said entry, and are herein corrected. Two additional areas, numbered 23 and 24, are also being included in this resubmission.

Taylor West Weber Water Improvement District (the "District") desires to have all of the parcels to which it serves culinary water officially recognized by Weber County, Utah (the "County") as being within the District. It is the intent of the District that all parcels within the described areas on the attached sheets be included on the County's official records as being part of the District, taxable by the County for the District, according to applicable law.

Area 1 (Completely within Hooper City) ^{A.} ^{T.} 08-047-0050 ✓
A parcel of land in the Northwest 1/4 of Section 7, T5N, R2W, Salt Lake Base and Meridian, Weber County, Utah, described as having a POINT OF BEGINNING being S00°40'E 70.00 feet along the N-S 1/4 line of said Section 7, from the North 1/4 corner of said Section 7; thence continuing S00°40'E 150.00 feet along the N-S 1/4 line of said Section 7; thence S89°20'W 290.00 feet; thence N00°40'W 149.54 feet; thence N89°14'30"E 290.00 feet to the Point of Beginning.

Area 2 (Completely within Hooper City) ^{A.} 08-308-0004 ✓
A parcel of land in the Southwest 1/4 of Section 6, T5N, R2W, Salt Lake Base and Meridian, Weber County, Utah, being the South 301.01 feet of Lot 3 of "Westland Subdivision", a subdivision as recorded in Book 47 on Page 087 of Weber County Records.

Area 3 (Completely within Hooper City) ^{A.} 08-366-0001, 0003 ✓
08-039-0020, 0027, 0016 ✓
All of Lot 1 of "Mosquito Ranch Subdivision" as recorded in Book 42 on Page 077 of Weber County Records, all of Lot 1B of a Division of "Jolly Ranch Estate Subdivision" as recorded in Book 32 on Page 014 of Weber County Records, all of Lot 1 and all of Lot 3 of "Stoddard and Finster Subdivision" as recorded in Book 52 on Page 088 of Weber County Records, being subdivisions of part of the Northwest 1/4 of Section 6, T5N, R2W, Salt Lake Base and Meridian, Weber County, Utah; also the following described parcel: having a POINT OF BEGINNING being the Northeast corner of Lot 1 of said "Stoddard and Finster Subdivision"; thence North along the West right-of-way line of

Q:\TWWW\VID\Word Docs\Annexation docs\03-26-08 TWW annexation of 24 areas.doc

Received

MAY 01 2008

Gary R. Herbert
Lieutenant Governor

5500 West Street 151.00 feet; thence N85°56'21"W 300.50 feet; thence S00°44'58"W 167.06 feet; thence S89°00'11"E 300.00 feet to the Point of Beginning.

Area 4 (Completely within Hooper City) ^{=A} 15-082-0013

A parcel of land in the Southeast 1/4 of Section 31, T6N, R2W, Salt Lake Base and Meridian, Weber County, Utah, being all of Lot 1 of "Gooch Subdivision", a subdivision as recorded in Book 36 on Page 010 of Weber County Records.

Area 5 (Completely within unincorporated Weber County) ^{=A} 15-082-0009, 0011, 0015, 0003

A parcel of land in the Northeast 1/4 of Section 31, T6N, R2W, Salt Lake Base and Meridian, Weber County, Utah, being the South 660.00 feet of the Southeast 1/4 of the Northeast 1/4 of said Section 31.

Area 6 (Completely within unincorporated Weber County) ^{=A} 15-238-0001 to 0003 15-250-0001 15-081-0001, 0031, 0040, 0021

15-242-0001 to 0003

A parcel of land in the East 1/2 of Section 30, T6N, R2W, Salt Lake Base and Meridian, Weber County, Utah, described as having a POINT OF BEGINNING being 0039, 0042, S00°41'31"W 473.29 feet along the East line of said Section 30, from the Northeast 0002, 0036, corner of said Section 30; thence continuing S00°41'31"W 2181.03 feet along the East 0026, 0020, line of said Section 30 to the East 1/4 corner of said Section 30; thence S00°43'08"W 0029, 0004, 660.00 feet along the East line of said Section 30; thence N89°16'52"W 1320.00 feet; thence N00°43'08"E 660.00 feet; thence N89°16'52"W 1274.56 feet; thence 15-200-0001, N01°00'00"E 1770.26 feet; thence S88°28'00"E 664.00 feet; thence S01°32'00"W 10.00 0002, feet; thence S88°28'00"E 17.00 feet; thence N01°32'00"E 10.00 feet; thence 15-257-0001, S88°28'00"E 113.00 feet; thence S88°15'00"E 472.00 feet; thence S88°56'00"E 824.63 to 0003, feet; thence N00°41'31"E 274.27 feet; thence S89°25'52"E 177.55 feet; thence N00°41'31"E 160.01 feet; thence S89°25'52"E 317.05 feet to the Point of Beginning.

Area 7 (Completely within unincorporated Weber County) ^{=A} 15-052-0032, 0048, 0029, 0030, 0031

A parcel of land in the North 1/2 of Section 19, T6N, R2W, Salt Lake Base and Meridian, Weber County, Utah, described as having a POINT OF BEGINNING being N86°44'10"W 1980.00 feet along the North line of said Section 19, from the Northeast corner of said Section 19; thence S01°30'15"W 1870.01 feet; thence N89°14'49"W 1105.26 feet; thence N00°45'11"E 90.00 feet; thence N89°14'51"W 1190.16 feet; thence N02°30'50"E 326.57 feet to a point on the centerline of the Weber River; thence the following six courses along the centerline of the Weber River: (1)N50°26'19"E 509.87 feet, (2)N47°00'36"E 97.11 feet, (3)N52°55'00"E 400.00 feet, (4)N39°23'45"E 335.34 feet, (5)N20°39'09"E 316.32 feet, and (6)N05°57'37"E 305.16 feet to a point of intersection of the centerline of the Weber River with the North line of said Section 19; thence S86°44'10"E 1191.43 feet along the North line of said Section 19 to the Point of Beginning.

Area 8 (Completely within unincorporated Weber County) ^{=A} 15-053-0003, 0032, 0027, 0001, 0025, 0008, 0002, 0028, 0030, 0031, 0007, 15-051-0002, 0003

A parcel of land in part of the East 1/2 of Section 18, T6N, R2W, Salt Lake Base and Meridian, Weber County, Utah, described as having a POINT OF BEGINNING being

the East 1/4 corner of said Section 18; thence South 1320.00 feet along the East line of said Section 18; thence West 1402.50 feet; thence North 1320.00 feet to a point on the E-W 1/4 line of said Section 18; thence East 429.00 feet along the E-W 1/4 line to a point on the centerline of the Weber River; thence Southerly, Easterly, and Northerly along the centerline of the Weber River to a point which is 1963.50 feet North of the E-W 1/4 line of said Section 18; thence East 792.00 feet to a point on the East line of said Section 18; thence South 1963.50 feet along the East line of said Section 18 to the Point of Beginning.

^{=A}
Area 9 (Completely within unincorporated Weber County) 15-043-0053

A parcel of land in part of the Southeast 1/4 of Section 15, T6N, R2W, Salt Lake Base and Meridian, Weber County, Utah, described as having a POINT OF BEGINNING being on the West right-of-way line of 2950 West 117.20 feet North of the South line of said Section 15 and Northeasterly 150.00 feet along the West right-of-way line of 2950 West; thence West 290.00 feet; thence North 150.00 feet; thence East to the West right-of-way line of 2950 West; thence Southwesterly Along the West right-of-way line of 2950 West to the Point of Beginning.

^{=A}
Area 10 and 11 (Completely within unincorporated Weber County) 15-060-0124, 0065,

A parcel of land in parts of Section 22 and Section 23, T6N, R2W, Salt Lake Base and Meridian, Weber County, Utah, described as having a POINT OF BEGINNING being the Northeast corner of said Section 22; thence S00°41'10"W 723.71 feet along the section line between Section 22 and Section 23; thence N86°03'39"E 152.28 feet; thence S04°52'40"W 304.15 feet; thence S86°03'39"W 129.98 feet; thence S00°41'10"W 1611.03 feet along the section line between Section 22 and Section 23; thence N89°09'34"W 800.11 feet along the E-W 1/4 of said Section 22; thence South 22.52 feet; thence N88°53'06"W 386.67 feet to a point on the East right-of-way line of 2900 West; thence N29°16'16"E 23.50 feet along the East right-of-way line of 2900 West; thence N89°09'34"W 799.96 feet along the E-W 1/4 line of said Section 22 to a point on the centerline of a canal; thence Southwesterly along the centerline of a canal the following three courses: (1) S46°20'26"W 505.78 feet, (2) S44°35'26"W 196.50 feet, and (3) S43°15'26"W 249.97 feet; thence N00°47'26"E 680.99 feet to the Center Corner of said Section 22; thence N89°09'34"W 218.40 feet along the E-W 1/4 line of said Section 22; thence N00°43'39"E 805.01 feet to a point on the South right-of-way line of the Southern Pacific Railroad; thence S89°14'16"E 2123.17 feet along the South right-of-way line of the Southern Pacific Railroad to a point on the East right-of-way line of 2900 West; thence N29°16'16"E 345.61 feet along the East right-of-way line of 2900 West to a point on the North right-of-way line of 1200 South; thence N89°13'06"W 731.46 feet along the North right-of-way line of 1200 South; thence North 1521.47 feet to a point on the North line of said Section 22; thence S89°19'39"E 1320.00 feet along the North line of said Section 22 to the Point of Beginning.

^{=A}
Area 12 (Completely within unincorporated Weber County) 0076, 0063, 0039, 0129, 0047, 0061, 0062

15-436-0001 to 0020

All of "Wally's Acre Cluster Subdivision 3", a subdivision of part of the Northwest 1/4 of Section 27, T6N, R2W, Salt Lake Base and Meridian, Weber County, Utah, as recorded in Book 65 on Page 091 of Weber County Records.

15-437-0001 to 0006

Area 13 (Completely within West Haven City)

15-076-0092, 0063, 0117,

A parcel of land in the Northeast 1/4 of Section 27, T6N, R2W, Salt Lake Base and Meridian, Weber County, Utah, described as having a POINT OF BEGINNING being the North 1/4 corner of said Section 27; thence East 453.00 feet along the North line of said Section 27, thence South 578.00 feet; thence West 300.00 feet; thence South 742.00 feet; thence West 153.00 feet; thence North 1320.00 feet along the N-S 1/4 line of said Section 27 to the Point of Beginning.

0064, 0051

Area 14 (Completely within West Haven City)

15-406-0006

Lot 71 "Windsor Farms Subdivision Phase 2", a subdivision of part of the Northwest 1/4 of Section 34, T6N, R2W, Salt Lake Base and Meridian, Weber County, Utah, as recorded in Book 62 on Page 014 of Weber County Records.

Area 15 (Completely within unincorporated Weber County)

08-037-0132

Lot 71 "Favero Subdivision", a subdivision of part of the Northeast 1/4 of Section 5, T5N, R2W, Salt Lake Base and Meridian, Weber County, Utah, as recorded in Book 45 on Page 001 of Weber County Records.

Area 16 (Completely within unincorporated Weber County)

08-037-0002, 0003

A parcel of land in part of the Northeast 1/4 of Section 5, T5N, R2W, Salt Lake Base and Meridian, Weber County, Utah, described as having a POINT OF BEGINNING being East 2480.00 feet along the North line of said Section 5 from the North 1/4 corner of said Section 5 and South 33.00 feet to a point on the South right-of-way line of 3300 South; thence East 103.50 feet along the South right-of-way line of 3300 South; thence South 841.75 feet; thence West 103.50 feet; thence North 841.75 feet to the Point of Beginning.

Area 17 (Completely within unincorporated Weber County)

08-029-0011

A parcel of land in part of the Northeast 1/4 of Section 4 and the Northwest 1/4 of Section 3, T5N, R2W, Salt Lake Base and Meridian, Weber County, Utah, described as having a POINT OF BEGINNING being N00°53'10"E 1679.74 feet along the line between said Section 3 and said Section 4; thence continuing along said line N00°53'10"E 234.75 feet; thence N89°06'50"W 200.00 feet; thence N00°53'10"E 72.00 feet; thence S89°06'50"E 200.00 feet; thence S89°13'53"E 429.00 feet; thence S00°53'10"W 156.75 feet; thence N89°13'53"W 122.00 feet; thence S00°53'10"W 150.00 feet; thence N89°13'53"W 307.00 feet to the Point of Beginning.

08-035-0019

08-387-0001

Area 18 (Completely within West Haven City)

15-094-0053, 0085, 0052, 0073,

A parcel of land in part of the East 1/2 of Section 35, T6N, R2W, Salt Lake Base and Meridian, and in part of the Northeast 1/4 of Section 2, T5N, R2W, Salt Lake Base and Meridian, described as having a POINT OF BEGINNING being the Southwest corner of said Section 35; thence N00°54'04"E 2653.97 feet along the West line of said Section 35 to the West 1/4 corner of said Section 35; thence N00°43'06"E 150.00 feet along the

0072, 0034,

0063, 0042,

0059, 0057

15-096-0019,

15-409-0001, 0002, 0003,

0004, 0008,

15-456-0001 to 0003

15-094-0032, 0031,

0030, 0080, 0029,

0038, 0070,

08-028-0045

West line of said Section 35; thence S89°21'42"E 604.80 feet; thence South 150.01 feet to a point on the E-W 1/4 line of said Section 35; thence S89°21'42"E 688.23 feet along the E-W 1/4 of said Section 35 to a point on the Westerly line of the Layton Canal; thence along the Westerly line of the Layton Canal the following ten courses:
 (1)S36°16'48"W 56.12 feet, (2)154.97 feet along the arc of a curve to the left that has a radius of 250.00 feet and is subtended by a long chord with a bearing of S18°31'18"W and a length of 152.50 feet, (3)S00°45'47"W 1079.53 feet, (4)87.60 feet along the arc of a curve to the right that has a radius of 100.00 feet and is subtended by a long chord with a bearing of S25°51'32"W and a length of 84.83 feet, (5)S50°57'17"W 1087.44 feet, (6)130.63 feet along the arc of a curve to the left that has a radius of 150.00 feet and is subtended by a long chord with a bearing of S26°00'21"W and a length of 126.54 feet, (7)S01°03'25"W 499.40 feet, (8)S01°31'06"W 178.54 feet, (9) 164.49 feet along the arc of a curve to the right that has a radius of 105.00 feet and is subtended by a long chord with a bearing of S46°23'53"W and a length of 148.18 feet, and (10)N88°43'20"W 186.52 feet to a point on the West line of said Section 2; thence N00°51'40"E 281.00 feet along the West line of said Section 2 to the Point of Beginning.

^{=A}
 Area 19 (Completely within West Haven City) 08-330-0001, 0002
 A parcel of land in part of the East 1/2 of Section 3, T5N, R2W, Salt Lake Base and Meridian, and in part of the Southwest 1/4 of Section 2, T5N, R2W, Salt Lake Base and Meridian, described as having a POINT OF BEGINNING being S00°51'40"W 369.25 feet along the East line of said Section 3 from the Northeast corner of said Section 3 to a point on the South line of the Layton Canal; thence the following three courses along said line of the Layton Canal: (1)S89°12'02"E 173.38 feet, (2)116.09 feet along the arc of a curve to the left that has a radius of 269.54 feet and is subtended by a long chord with a bearing of N78°59'04"E and a length of 115.20 feet, and (3)N52°03'37"E 37.22 feet; thence S00°51'40"W 338.30 feet; thence N89°06'16"W 15.12 feet; thence S00°51'40"W 303.65 feet; thence S89°06'16"E 4.00 feet; thence S00°51'40"W 330.00 feet; thence S88°58'51"E 861.01 feet; thence S00°51'40"W 820.21 feet; thence S89°11'46"E 198.30 feet; thence S00°41'43"W 532.34 feet to a point on the E-W 1/4 line of said Section 2; thence S88°58'51"E 14.51 feet along the E-W 1/4 line of said Section 2 to a point on the Northwest right-of-way line of Midland Drive; thence S44°28'33"W 1444.34 feet along the Northwest right-of-way line of Midland Drive; thence North 87.63 feet; thence N89°11'25"W 381.69 feet to a point on the East line of said Section 3; thence S00°51'40"W 270.03 feet along the East line of said Section 3; thence N89°23'55"W 183.00 feet; thence S00°51'40"W 10.00 feet; thence N89°23'55"W 44.00 feet; thence S00°44'58"W 297.33 feet; thence N89°35'55"W 161.94 feet; thence S00°41'19"W 127.57 feet; thence B89°42'13"W 927.49 feet; thence N00°09'29"E 361.21 feet; thence N89°23'55"W 769.00 feet; thence South 5.93 feet; thence N89°54'31"W 317.94 feet; thence N08°06'24"E 300.10 feet to a point on the Easterly line of the Layton Canal; thence along the Easterly line of the Layton Canal the following six courses:
 (1)N19°06'24"E 896.34 feet, (2)62.50 feet along the arc of a curve to the right that has a radius of 50.00 feet and is subtended by a long chord with a bearing of N54°54'59"E and a length of 58.51 feet, (3)S89°16'25"E 720.78 feet, (4)N00°51'35"E 1429.02 feet, (5)87.02 feet along the arc of a curve to the right that has a radius of 100.00 feet and is

08-029-0022, 0013, 0041, 0015, 0004, 0005
 08-033-0001 to 0011, 0014 to 0018
 08-342-0001 to 0003, 0005
 08-030-0034, 0041, 0040, 0046, 0006, 0007, 0009, 0010, 0023, 0028

08-028-0054
 0055, 0052,
 0047, 0003,
 0004, 0005,
 0006, 0007,
 0008, 0010,
 0024, 0025,
 0038, 0009,
 0026, 0014,
 0036

08-386-0001
 08-028-0057
 08-022-0042,
 0041,
 0033,
 0035, 0032,
 0037, 0045,
 0004, 0003,
 0039, 0004,
 0002, 0003, 0046, 0001,
 0006, 0005, 0043, 0017,
 0049

08-438-0001,
 0004 to 0016,
 0002, 0003

08-032-0002, 0003, 0004,
 0017, 0030, 0012, 0016,
 0023, 0006 to 0011

subtended by a long chord with a bearing of N25°47'18"E and a length of 84.30 feet, and (6) N50°43'00"E 706.45 feet; thence S87°43'53"E 744.70 feet to a point on the East line of said Section 3; thence N00°51'40"E 479.15 feet along the East line of said Section 3 to the Point of Beginning.

Area 20 (Completely within West Haven City)

^{=A} 08-028-0050, 0012, 0017, 0034

A parcel of land in part of the Northwest 1/4 of Section 2, T5N, R2W, Salt Lake Base and Meridian, Weber County, Utah, described as having a POINT OF BEGINNING being S88°29'17"E 1744.01 feet along the E-W 1/4 line of said Section 2 from the West 1/4 corner of said Section 2; thence N45°27'30"W 177.34 feet to a point on the SE line of Midland Drive; thence N44°32'30"E 68.85 feet along the said SE line; thence N45°27'30"W 356.40 feet; thence N44°32'30"E 150.00 feet; thence S45°27'30"E 356.40 feet to a point on the said SE line; thence N44°32'30"E 481.89 feet along the said SE line; thence S45°27'30"E 737.60 feet; thence S00°17'30"E 130.00 feet along the N-S 1/4 line of said Section 2; thence N88°29'17"W 891.81 feet along the E-W 1/4 line of said Section 2 to the Point of Beginning.

Area 21 (Completely within West Haven City)

^{=A}

A parcel of land in part of Section 3, T5N, R2W, Salt Lake Base and Meridian and in part of Section 4, T5N, R2W, Salt Lake Base and Meridian, Weber County, Utah, described as having a POINT OF BEGINNING being S00°53'10"W 1923.32 feet from the Northwest corner of said Section 3; thence S89°15'20"E 363.00 feet; thence S00°53'10"W 629.18 feet to a point on the E-W 1/4 line of said Section 3; thence S89°15'20"E 257.06 feet along the E-W 1/4 line of said Section 3; thence North 33.00 feet; thence N33°59'40"E 171.63 feet; thence N30°45'59"E 137.06 feet; thence S89°15'20"E 87.32 feet; thence S00°44'40"W 295.20 feet to a point on the E-W 1/4 line of said Section 3; thence S89°15'20"E 1470.57 feet along the E-W 1/4 line of said Section 3; thence N00°49'58"E 323.40 feet; thence S89°15'20"E 150.00 feet, thence N00°36'56"E 309.60 feet; thence S89°15'20"E 150.00 feet; thence N00°43'35"E 687.00 feet; thence S89°16'25"E 1224.59 feet to a point on the Westerly line of the Layton Canal; thence along the westerly line of the Layton Canal the following two courses, (1) 33.92 feet along the arc of a curve to the left that has a radius of 200.00 feet and is subtended by a long chord with a bearing of S05°43'05"W and a length of 33.88 feet and (2) S00°51'35"W 1286.26 feet to a point on the E-W 1/4 line of said Section 3; thence N89°16'25"W 621.12 feet along the E-W 1/4 line of said Section 3; thence S00°43'35"W 33.00 feet to a point on the West line of the Layton Canal; thence along the westerly line of the Layton Canal the following five courses, (1) 200.00 feet along the arc of a curve to the left that has a radius of 160.00 feet and is subtended by a long chord with a bearing of S54°55'00"W and a length of 187.23 feet, (2) S70°53'36"E 10.00 feet, (3) S19°06'24"W 965.70 feet, (4) 36.40 feet along the arc of a curve to the left that has a radius of 200.00 feet and is subtended by a long chord with a bearing of S13°36'24"W and a length of 38.34 feet, and (5) S08°06'24"W 228.96 feet; thence N89°20'54"W 2751.19 feet to a point on the Section line between said Section 3 and said Section 4; thence N00°47'15"E 719.00 feet along the Section line between said Section 3 and said Section 4; thence West 310.00 feet; thence North 150.00 feet; thence West 161.63 feet; thence S82°39'38"W

Q:\T\W\WID\Word Docs\Annexation docs\03-26-08 TWW annexation of 24 areas.doc

08-029-0027, 0020, 0030, 0029, 0009, 0019, 0034, 0044, 0021

08-030-0016, 0031, 0017, 0018, 0049, 0050, 0021

08-429-0001

08-034-0039, 0006, 0009, 0040, 0010, 0038,

08-029-0003

0025, 0011, 0012, 0013, 0014, 0024, 0015,

08-036-0004, 0002, 0022

0037, 0022, 0016, 0018

08-035-0029, 0032, 0034, 0035, 0036, 0010

08-406-0001 to 0009

08-211-0001 to 0017, 0018 to 0022

08-211-0023 to 0031

08-447-0001, 0002

08-226-0001 to 0006

08-205-0001 to 0008

08-203-0001 to 0004

1529.52 feet; thence N00°44'26"E 557.17 feet; thence N89°06'02"W 10.92 feet; thence 314.31 feet along the arc of a curve to the left that has a radius of 330.11 feet and is subtended by a long chord with a bearing of S63°37'19"W and a length of 302.57 feet; thence N53°39'18"W 30.00 feet; thence N89°17'29"W 125.67 feet; thence N00°44'02"E 341.22 feet; thence 124.31 feet along the arc of a curve to the right that has a radius of 50.00 feet and is subtended by a long chord with a bearing of N55°03'23"W and a length of 94.68 feet; thence N89°17'40"W 519.64 feet; thence S36°35'41"W 184.45 feet; thence West 1505.63 feet; thence North 1320.00 feet; thence East 1980.00 feet; thence S00°40'38"W 297.02 feet; thence East 156.04 feet; thence S00°24'08"W 296.99 feet; thence S89°06'04"E 2508.00 feet to the Point of Beginning.

Area 22 (Completely within West Haven City) ^A 08-022-0036 ✓

A parcel of land part of the Southwest 1/4 of Section 2, T5N, R2W, Salt Lake Base and Meridian, Weber County, Utah, described as having a POINT OF BEGINNING being S89°14'41"E 1501.86 feet along the E-W 1/4 line of said Section 2 to a point on the Southeast right-of-way line of Midland Drive and S44°29'10"W 398.94 feet along the Southeast right-of-way line of Midland Drive from the East 1/4 corner of said Section 2; thence S45°30'50"E 161.01 feet; thence S44°29'10"W 108.29 feet; thence N45°30'50"W 161.01 feet to a point on the Southeast right-of-way line of Midland Drive; thence N44°29'10"E 108.29 feet along the Southeast right-of-way line of Midland Drive to the Point of Beginning.

Area 23 (Completely within West Haven City) 08-037-0001 ✓

A parcel of land in the Northeast 1/4 of Section 5, T5N, R2W, Salt Lake Base and Meridian, U.S. survey, beginning 1436.5 feet East from the Northwest corner of said 1/4 Section, and running thence East 1200 feet; thence South 874.75 feet; thence East 103.5 feet; thence South 461.75 feet; thence West 1267 feet; thence North 1336.5 feet to the Point of Beginning.

Excepting there from: A parcel of land in the Northeast 1/4 of Section 5, T5N, R2W, Salt Lake Base and Meridian, U.S. survey, described as follows: beginning at a point on the centerline of 3300 south street, said point being N88d34'02"W 652.90 feet from the Northeast corner of said section 5; thence S01d25'58"W 240.00 feet; thence N88d34'02"W 200.00 feet; thence N01d25'58"E 240.00 feet to said centerline; thence S88d34'02"E along said centerline 200.00 feet to the Point of Beginning.

Area 24 (Completely within West Haven City) T ?

A parcel of land part of lot 4 of the Northwest 1/4 of Section 1, T5N, R2W, Salt Lake Base and Meridian, U.S. survey, beginning at a point on the South line of said lot 4, 304 feet east from the southwest corner and running thence North 330 feet; thence East 1016 feet, more or less, to the East line of lot 4; thence South 330 feet to the South line of lot 4; thence West 1016 feet, more or less, to the Point of Beginning.

Prepared by Robert C. Shepherd

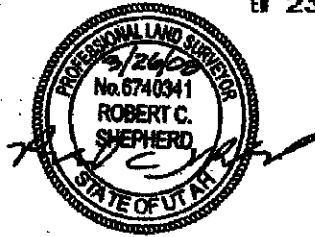

Approved:

Val Surrage
Val Surrage, Manager,
Taylor-West Weber Water Improvement District

3-26-2008
Date

ACKNOWLEDGEMENT

State of Utah)
County of Weber) §

On this 26 day of March, 2008, before me, Shelley P Hadley, a notary public, personally appeared Val Surrage, proved on the basis of satisfactory evidence to be the person whose name is subscribed to this instrument, and acknowledged he executed the same. Witness my hand and official seal.

Shelley P. Hadley
Notary Public



Notary Seal



"W2318044"

EN 2318044 PG 1 OF 11
ERNEST D ROWLEY, WEBER COUNTY RECORDER
28-JAN-08 234 PM FEE \$1.00 DEP JPH
REC FOR: TAYLOR WEST WEBER WATER

**TAYLOR WEST WEBER WATER IMPROVEMENT
DISTRICT
4660 WEST 1150 SOUTH
OGDEN, UTAH 84404**

Narration:

Taylor West Weber Water Improvement District (the "District") desires to have all of the parcels to which it serves culinary water officially recognized by Weber County, Utah (the "County") as being within the District. It is the intent of the District that all parcels within the described areas on the attached sheets and visually represented in the attached map, "Taylor West Weber Water District" be included on the County's official records as being part of the District, taxable by the County for the District, according to applicable law.

Area 1 (Completely within Hooper City) 08-047-0050

A parcel of land in the Northwest 1/4 of Section 7, T5N, R2W, Salt Lake Base and Meridian, Weber County, Utah, described as having a POINT OF BEGINNING being S00°40'E 70.00 feet along the N-S 1/4 line of said Section 7, from the North 1/4 corner of said Section 7; thence continuing S00°40'E 150.00 feet along the N-S 1/4 line of said Section 7; thence S89°20'W 290.00 feet; thence N00°40'W 149.54 feet; thence N89°14'30"E 290.00 feet to the Point of Beginning.

Area 2 (Completely within Hooper City) 08-308-0004

A parcel of land in the Southwest 1/4 of Section 6, T5N, R2W, Salt Lake Base and Meridian, Weber County, Utah, being the South 301.01 feet of Lot 3 of "Westland Subdivision", a subdivision as recorded in Book 47 on Page 087 of Weber County Records.

Area 3 (Completely within Hooper City) 08-316-0001, 0003, 0016
08-039-0020, 0027, 0016

All of Lot 1 of "Mosquito Ranch Subdivision" as recorded in Book 42 on Page 077 of Weber County Records, all of Lot 1B of a Division of "Jolly Ranch Estate Subdivision" as recorded in Book 32 on Page 014 of Weber County Records, all of Lot 1 and all of Lot 3 of "Stoddard and Finster Subdivision" as recorded in Book 52 on Page 088 of Weber County Records, being subdivisions of part of the Northwest 1/4 of Section 6, T5N, R2W, Salt Lake Base and Meridian, Weber County, Utah; also the following described parcel: having a POINT OF BEGINNING being the Northeast corner of Lot 1 of said "Stoddard and Finster Subdivision"; thence North along the West right-of-way line of 5500 West Street 151.00 feet; thence N85°56'21"W 300.50 feet; thence S00°44'58"W 167.06 feet; thence S89°00'11"E 300.00 feet to the Point of Beginning.

Q:\T\WWW\IDWord Docs\Annexation docs\2008-0-21 legal description of areas served_to be annexed.doc

Received

MAY 01 2008

Gary R. Herbert
Lieutenant Governor

Area 4 (Completely within Hooper City) 15-082-0013

A parcel of land in the Southeast 1/4 of Section 31, T6N, R2W, Salt Lake Base and Meridian, Weber County, Utah, being all of Lot 1 of "Gooch Subdivision", a subdivision as recorded in Book 36 on Page 010 of Weber County Records.

Area 5 (Completely within unincorporated Weber County) 15-082-0009, 0011, 0015, 0002

A parcel of land in the Northeast 1/4 of Section 31, T6N, R2W, Salt Lake Base and Meridian, Weber County, Utah, being the South 660.00 feet of the Southeast 1/4 of the Northeast 1/4 of said Section 31.

Area 6 (Completely within unincorporated Weber County) 15-238-0001 to 0003, 15-250-0001, 15-081-0001, 0031, 0040, 0021,

15-212-0001 to 0003

A parcel of land in the East 1/2 of Section 30, T6N, R2W, Salt Lake Base and Meridian, Weber County, Utah, described as having a POINT OF BEGINNING being 0039, 0042, S00°41'31"W 473.29 feet along the East line of said Section 30, from the Northeast 0002, 0036 corner of said Section 30; thence continuing S00°41'31"W 2181.03 feet along the East line of said Section 30 to the East 1/4 corner of said Section 30; thence S00°43'08"W 0026, 0030, 660.00 feet along the East line of said Section 30; thence N89°16'52"W 1320.00 feet; 0029, 0004 thence N00°43'08"E 660.00 feet; thence N89°16'52"W 1274.56 feet; thence N01°00'00"E 1770.26 feet; thence S88°28'00"E 664.00 feet; thence S01°32'00"W 10.00 feet; thence S88°28'00"E 17.00 feet; thence N01°32'00"E 10.00 feet; thence 15-200-0001, S88°28'00"E 113.00 feet; thence S88°15'00"E 472.00 feet; thence S88°56'00"E 824.63 0002 feet; thence N00°41'31"E 274.27 feet; thence S89°25'52"E 177.55 feet; thence 15-257-0001 N00°41'31"E 160.01 feet; thence S89°25'52"E 317.05 feet to the Point of Beginning. to 0003

Area 7 (Completely within unincorporated Weber County) 15-052-0032, 0048, 0029,

A parcel of land in the North 1/2 of Section 19, T6N, R2W, Salt Lake Base and Meridian, Weber County, Utah, described as having a POINT OF BEGINNING being 0030, 0031 N86°44'10"W 1980.00 feet along the North line of said Section 19, from the Northeast corner of said Section 19; thence S01°30'15"W 1870.01 feet; thence N89°14'49"W 1105.26 feet; thence N00°45'11"E 90.00 feet; thence N89°14'51"W 1190.16 feet; thence 15-326-0001 N02°30'50"E 326.57 feet to a point on the centerline of the Weber River; thence the following six courses along the centerline of the Weber River: (1)N50°26'19"E 509.87 feet, (2)N47°00'36"E 97.11 feet, (3)N52°55'00"E 400.00 feet, (4)N39°23'45"E 335.34 feet, (5)N20°39'09"E 316.32 feet, and (6)N05°57'37"E 305.16 feet to a point of intersection of the centerline of the Weber River with the North line of said Section 19; thence S86°44'10"E 1191.43 feet along the North line of said Section 19 to the Point of Beginning.

15-053-0003, 0032, 0027, 0028, 0030, 0031, 0007, 0002, 0008, 0025, 0001

Area 8 (Completely within unincorporated Weber County) 15-051-0002, 0003

A parcel of land in part of the East 1/2 of Section 18, T6N, R2W, Salt Lake Base and Meridian, Weber County, Utah, described as having a POINT OF BEGINNING being the East 1/4 corner of said Section 18; thence South 1320.00 feet along the East line of said Section 18; thence West 1402.50 feet; thence North 1320.00 feet to a point on the E-W 1/4 line of said Section 18; thence East 429.00 feet along the E-W 1/4 line to a point on the centerline of the Weber River; thence Southerly, Easterly, and Northerly along the centerline of the Weber River to a point which is 1963.50 feet North of the E-W 1/4 line of said Section 18; thence East 792.00 feet to a point on the East line of said Section 18; thence South 1963.50 feet along the East line of said Section 18 to the Point of Beginning.

Area 9 (Completely within unincorporated Weber County) 15-043-0053

A parcel of land in part of the Southeast 1/4 of Section 15, T6N, R2W, Salt Lake Base and Meridian, Weber County, Utah, described as having a POINT OF BEGINNING being on the West right-of-way line of 2950 West 117.20 feet North of the South line of said Section 15 and Northeasterly 150.00 feet along the West right-of-way line of 2950 West; thence West 290.00 feet; thence North 150.00 feet; thence East to the West right-of-way line of 2950 West; thence Southwesterly Along the West right-of-way line of 2950 West to the Point of Beginning.

Area 10 and 11 (Completely within unincorporated Weber County) 15-060-0124, 0065,

A parcel of land in parts of Section 22 and Section 23, T6N, R2W, Salt Lake Base and Meridian, Weber County, Utah, described as having a POINT OF BEGINNING being the Northeast corner of said Section 22; thence S00°41'10"W 723.71 feet along the section line between Section 22 and Section 23; thence N86°03'39"E 152.28 feet; thence S04°52'40"W 304.15 feet; thence S86°03'39"W 129.98 feet; thence S00°41'10"W 1611.03 feet along the section line between Section 22 and Section 23; thence N89°09'34"W 800.11 feet along the E-W 1/4 of said Section 22; thence South 22.52 feet; thence N88°53'06"W 386.67 feet to a point on the East right-of-way line of 2900 West; thence N29°16'16"E 23.50 feet along the East right-of-way line of 2900 West; thence N89°09'34"W 799.96 feet along the E-W 1/4 line of said Section 22 to a point on the centerline of a canal; thence Southwesterly along the centerline of a canal the following three courses: (1)S46°20'26"W 505.78 feet, (2)S44°35'26"W 196.50 feet, and (3)S43°15'26"W 249.97 feet; thence N00°47'26"E 680.99 feet to the Center Corner of said Section 22; thence N89°09'34"W 218.40 feet along the E-W 1/4 line of said Section 22; thence N00°43'39"E 805.01 feet to a point on the South right-of-way line of the Southern Pacific Railroad; thence S89°14'16"E 2123.17 feet along the South right-of-way line of the Southern Pacific Railroad to a point on the East right-of-way line of 2900 West; thence N29°16'16"E 345.61 feet along the East right-of-way line of 2900 West to a point on the North right-of-way line of 1200 South; thence N89°13'06"W 731.46 feet along the North right-of-way line of 1200 South; thence North 1521.47 feet to a point on the North line of said Section 22; thence S89°19'39"E 1320.00 feet along the North line of said Section 22 to the Point of Beginning.

0121, 0060,
0100, 0131,
0026,
0130, 0104,
0085,
0087, 0091,
0024, 0125,
0127, 0138,
0040,
0073, 0031,
0137,
0114,
0115,
0080,
0079, 0045, 0076, 0063,
0039, 0129, 0047, 0061,
0062

Area 12 (Completely within unincorporated Weber County) 15-436-0001 to 0020
 All of "Wally's Acre Cluster Subdivision 3", a subdivision of part of the Northwest 1/4
 of Section 27, T6N, R2W, Salt Lake Base and Meridian, Weber County, Utah, as
 recorded in Book 65 on Page 091 of Weber County Records. 15-437-0001 to 0006

Area 13 (Completely within West Haven City) 15-076-0092, 0063, 0117,
 A parcel of land in the Northeast 1/4 of Section 27, T6N, R2W, Salt Lake Base and
 Meridian, Weber County, Utah, described as having a POINT OF BEGINNING being 0064,
 the North 1/4 corner of said Section 27; thence East 453.00 feet along the North line of
 said Section 27, thence South 578.00 feet; thence West 300.00 feet; thence South 742.00
 feet; thence West 153.00 feet; thence North 1320.00 feet along the N-S 1/4 line of said
 Section 27 to the Point of Beginning. 0051

Area 14 (Completely within West Haven City) 15-406-0006
 Lot 71 "Windsor Farms Subdivision Phase 2", a subdivision of part of the Northwest 1/4
 of Section 34, T6N, R2W, Salt Lake Base and Meridian, Weber County, Utah, as
 recorded in Book 62 on Page 014 of Weber County Records.

Area 15 (Completely within unincorporated Weber County) 08-037-0132
 Lot 71 "Favero Subdivision", a subdivision of part of the Northeast 1/4 of Section 5,
 T5N, R2W, Salt Lake Base and Meridian, Weber County, Utah, as recorded in Book 45
 on Page 001 of Weber County Records.

Area 16 (Completely within unincorporated Weber County) 08-037-0002, 0003
 A parcel of land in part of the Northeast 1/4 of Section 5, T5N, R2W, Salt Lake Base and
 Meridian, Weber County, Utah, described as having a POINT OF BEGINNING being
 East 2480.00 feet along the North line of said Section 5 from the North 1/4 corner of said
 Section 5 and South 33.00 feet to a point on the South right-of-way line of 3300 South;
 thence East 103.50 feet along the South right-of-way line of 3300 South; thence South
 841.75 feet; thence West 103.50 feet; thence North 841.75 feet to the Point of Beginning.

Area 17 (Completely within unincorporated Weber County) 08-029-0011
 A parcel of land in part of the Northeast 1/4 of Section 4 and the Northwest 1/4 of
 Section 3, T5N, R2W, Salt Lake Base and Meridian, Weber County, Utah, described as
 having a POINT OF BEGINNING being N00°53'10"E 1679.74 feet along the line 08-035-0019
 between said Section 3 and said Section 4; thence continuing along said line
 N00°53'10"E 234.75 feet; thence N89°06'50"W 200.00 feet; thence N00°53'10"E 72.00
 feet; thence S89°06'50"E 200.00 feet; thence S89°13'53"E 429.00 feet; thence
 S00°53'10"W 156.75 feet; thence N89°13'53"W 122.00 feet; thence S00°53'10"W
 150.00 feet; thence N89°13'53"W 307.00 feet to the Point of Beginning. 08-387-0001

Area 18 (Completely within West Haven City)

A parcel of land in part of the East 1/2 of Section 35, T6N, R2W, Salt Lake Base and Meridian, and in part of the Northeast 1/4 of Section 2, T5N, R2W, Salt Lake Base and Meridian, described as having a POINT OF BEGINNING being the Southwest corner of said Section 35; thence N00°54'04"E 2653.97 feet along the West line of said Section 35 to the West 1/4 corner of said Section 35; thence N00°43'06"E 150.00 feet along the West line of said Section 35; thence S89°21'42"E 604.80 feet; thence South 150.01 feet to a point on the E-W 1/4 line of said Section 35; thence S89°21'42"E 688.23 feet along the E-W 1/4 of said Section 35 to a point on the Westerly line of the Layton Canal; thence along the Westerly line of the Layton Canal the following ten courses: (1)S36°16'48"W 56.12 feet, (2)154.97 feet along the arc of a curve to the left that has a radius of 250.00 feet and is subtended by a long chord with a bearing of S18°31'18"W and a length of 152.50 feet, (3)S00°45'47"W 1079.53 feet, (4)87.60 feet along the arc of a curve to the right that has a radius of 100.00 feet and is subtended by a long chord with a bearing of S25°51'32"W and a length of 84.83 feet, (5)S50°57'17"W 1087.44 feet, (6)130.63 feet along the arc of a curve to the left that has a radius of 150.00 feet and is subtended by a long chord with a bearing of S26°00'21"W and a length of 126.54 feet, (7)S01°03'25"W 499.40 feet, (8)S01°31'06"W 178.54 feet, (9) 164.49 feet along the arc of a curve to the right that has a radius of 105.00 feet and is subtended by a long chord with a bearing of S46°23'53"W and a length of 148.18 feet, and (10)N88°43'20"W 186.52 feet to a point on the West line of said Section 2; thence N00°51'40"E 281.00 feet along the West line of said Section 2 to the Point of Beginning.

15-094-0053, 0085, 0052, 0073, 0072, 0034,
 0063, 0042, 0059, 0057
 15-096-0019
 15-409-0001, 0002, 0003, 0004, 0008
 15-456-0001 to 0003
 15-094-0032, 0031, 0030, 0080, 0029, 0038, 0070
 08-028-0045

08-330-0001, 0002

08-028-0054, 0055, 0052, 0047, 0003, 0004, 0005, 0006, 0007, 0008, 0010, 0024

Area 19 (Completely within West Haven City)

A parcel of land in part of the East 1/2 of Section 3, T5N, R2W, Salt Lake Base and Meridian, and in part of the Southwest 1/4 of Section 2, T5N, R2W, Salt Lake Base and Meridian, described as having a POINT OF BEGINNING being S00°51'40"W 369.25 feet along the East line of said Section 3 from the Northeast corner of said Section 3 to a point on the South line of the Layton Canal; thence the following three courses along said line of the Layton Canal: (1)S89°12'02"E 173.38 feet, (2)116.09 feet along the arc of a curve to the left that has a radius of 269.54 feet and is subtended by a long chord with a bearing of N78°59'04"E and a length of 115.20 feet, and (3)N52°03'37"E 37.22 feet; thence S00°51'40"W 338.30 feet; thence N89°06'16"W 15.12 feet; thence S00°51'40"W 303.65 feet; thence S89°06'16"E 4.00 feet; thence S00°51'40"W 330.00 feet; thence S88°58'51"E 861.01 feet; thence S00°51'40"W 820.21 feet; thence S89°11'46"E 198.30 feet; thence S00°41'43"W 532.34 feet to a point on the E-W 1/4 line of said Section 2; thence S88°58'51"E 14.51 feet along the E-W 1/4 line of said Section 2 to a point on the Northwest right-of-way line of Midland Drive; thence S44°28'33"W 1444.34 feet along the Northwest right-of-way line of Midland Drive; thence North 87.63 feet; thence N89°11'25"W 381.69 feet to a point on the East line of said Section 3; thence S00°51'40"W 270.03 feet along the East line of said Section 3; thence N89°23'55"W 183.00 feet; thence S00°51'40"W 10.00 feet; thence N89°23'55"W 44.00 feet; thence S00°44'58"W 297.33 feet; thence N89°35'55"W 161.94 feet; thence S00°41'19"W 127.57 feet; thence N89°42'13"W 927.49 feet; thence N00°09'29"E 361.21 feet; thence N89°23'55"W 769.00 feet; thence South 5.93 feet; thence N89°54'31"W 317.94 feet; thence N08°06'24"E 300.10 feet to a point on the Easterly line of the Layton Canal; thence along the Easterly line of the Layton Canal the following six courses: (1)N19°06'24"E 896.34 feet, (2)62.50 feet along the arc of a curve to the right that has a radius of 50.00 feet and is subtended by a long chord with a bearing of N54°54'59"E and a length of 58.51 feet, (3)S89°16'25"E 720.78 feet, (4)N00°51'35"E 1429.02 feet, (5)87.02 feet along the arc of a curve to the right that has a radius of 100.00 feet and is subtended by a long chord with a bearing of N25°47'18"E and a length of 84.30 feet, and (6)N50°43'00"E 706.45 feet; thence S87°43'53"E 744.70 feet to a point on the East line of said Section 3; thence N00°51'40"E 479.15 feet along the East line of said Section 3 to the Point of Beginning.

08-030-0006, 0007, 0009 to 0015, 0023, 0028
 08-033-0001 to 0011, 0014 to 0018
 08-448-0001 to 0012
 08-029-0022, 0013, 0041, 0015, 0004, 0005
 08-438-0001, 0008 to 0016, 0002, 0003

0025, 0038, 0009, 0026, 0014, 0036, 08-386-0001, 08-028-0057, 08-022-0042, 0041, 0033, 0035, 0032, 0037, 0045, 0064, 0003, 0039, 0004, 0063, 0046, 0001, 0002, 0006, 0005, 0043, 0017, 0049

Area 20 (Completely within West Haven City)

A parcel of land in part of the Northwest 1/4 of Section 2, T5N, R2W, Salt Lake Base and Meridian, Weber County, Utah, described as having a POINT OF BEGINNING being S88°58'51"E 1884.69 feet from the West 1/4 corner of said Section 2; thence N43°57'00"W 647.54 feet; thence N46°03'00"E 150.00 feet; thence S43°57'00"E 374.86 feet to a point on the Southeast right-of-way line of Midland Drive; thence N46°03'00"E 550.74 feet along the Southeast right-of-way line of Midland Drive; thence S43°57'00"E 667.51 feet; thence S00°34'06"W 215.90 feet; thence N88°58'51"W 776.50 feet along the E-W 1/4 line of said Section 2 to the Point of Beginning.

08-028-0050, 0012, 0017, 0034
 08-028-0062 (08-028-0023)
 08-028-0064 (08-028-0011)
 08-028-0066 (08-028-0049)

Q:\T\WWW\ID\Word Docs\Annexation docs\2008-0-21 legal description of areas served to be annexed.doc

08-028-0023, 0011, 0049 = A.

Area 21 (Completely within West Haven City)

A parcel of land in part of Section 3, T5N, R2W, Salt Lake Base and Meridian and in part of Section 4, T5N, R2W, Salt Lake Base and Meridian, Weber County, Utah, described as having a POINT OF BEGINNING being S00°53'10"W 1923.32 feet from the Northwest corner of said Section 3; thence S89°15'20"E 363.00 feet; thence S00°53'10"W 629.18 feet to a point on the E-W 1/4 line of said Section 3; thence S89°15'20"E 257.06 feet along the E-W 1/4 line of said Section 3; thence North 33.00 feet; thence N33°59'40"E 171.63 feet; thence N30°45'59"E 137.06 feet; thence S89°15'20"E 87.32 feet; thence S00°44'40"W 295.20 feet to a point on the E-W 1/4 line of said Section 3; thence S89°15'20"E 1470.57 feet along the E-W 1/4 line of said Section 3; thence N00°49'58"E 323.40 feet; thence S89°15'20"E 150.00 feet, thence N00°36'56"E 309.60 feet; thence S89°15'20"E 150.00 feet; thence N00°43'35"E 687.00 feet; thence S89°16'25"E 1224.59 feet to a point on the Westerly line of the Layton Canal; thence along the westerly line of the Layton Canal the following two courses, (1)33.92 feet along the arc of a curve to the left that has a radius of 200.00 feet and is subtended by a long chord with a bearing of S05°43'05"W and a length of 33.88 feet and (2)S00°51'35"W 1286.26 feet to a point on the E-W 1/4 line of said Section 3; thence N89°16'25"W 621.12 feet along the E-W 1/4 line of said Section 3; thence S00°43'35"W 33.00 feet to a point on the West line of the Layton Canal; thence along the westerly line of the Layton Canal the following five courses, (1)200.00 feet along the arc of a curve to the left that has a radius of 160.00 feet and is subtended by a bearing of S54°55'00"W and a length of 187.23 feet, (2)S70°53'36"E 10.00 feet, (3)S19°06'24"W 965.70 feet, (4)36.40 feet along the arc of a curve to the left that has a radius of 200.00 feet and is subtended by a long chord with a bearing of S13°36'24"W and a length of 38.34 feet, and (5)S08°06'24"W 228.96 feet; thence N89°20'54"W 2751.19 feet to a point on the Section line between said Section 3 and said Section 4; thence N00°47'15"E 719.00 feet along the Section line between said Section 3 and said Section 4; thence West 310.00 feet; thence North 150.00 feet; thence West 161.63 feet; thence S82°39'38"W 1529.52 feet; thence N00°44'26"E 557.17 feet; thence N89°06'02"W 10.92 feet; thence 314.31 feet along the arc of a curve to the left that has a radius of 330.11 feet and is subtended by a long chord with a bearing of S63°37'19"W and a length of 302.57 feet; thence N53°39'18"W 30.00 feet; thence N89°17'29"W 125.67 feet; thence N00°44'02"E 341.22 feet; thence 124.31 feet along the arc of a curve to the right that has a radius of 50.00 feet and is subtended by a long chord with a bearing of N55°03'23"W and a length of 94.68 feet; thence N89°17'40"W 519.64 feet; thence S36°35'41"W 184.45 feet; thence West 1505.63 feet; thence North 1320.00 feet; thence East 1980.00 feet; thence S00°40'38"W 297.02 feet; thence East 156.04 feet; thence S00°24'08"W 296.99 feet; thence S89°06'04"E 2508.00 feet to the Point of Beginning.

08-029-0027, 0020, 0030, 0029, 0009, 0019, 0034, 0044, 0021

08-030-0016, 0031, 0017, 0018, 0049, 0050, 0021

08-429-0001, 08-034-0039, 0006, 0009, 0040, 0010, 0038, 0025, 0011, 0012, 0013, 0014, 0024, 0015, 0037, 0022, 0016, 0018

Q:\T\WWW\Word Docs\Annexation docs\2008-0-21 legal description of areas served to be annexed.doc

08-035-0029, 0032, 0034, 0035, 0036, 0010

08-406-0001 to 0009, 08-211-0001 to 0017, 0018 to 0022

08-211-0023 to 0031

08-447-0001, 0002

08-205-0001 to 0008

08-226-0001 to 0006

08-203-0001 to 0004

08-036-0004, 0002, 0022

Area 22 (Completely within West Haven City)

08-022-0036'

A parcel of land part of the Southwest 1/4 of Section 2, T5N, R2W, Salt Lake Base and Meridian, Weber County, Utah, described as having a POINT OF BEGINNING being S89°14'41"E 1501.86 feet along the E-W 1/4 line of said Section 2 to a point on the Southeast right-of-way line of Midland Drive and S44°29'10"W 398.94 feet along the Southeast right-of-way line of Midland Drive from the East 1/4 corner of said Section 2; thence S45°30'50"E 161.01 feet; thence S44°29'10"W 108.29 feet; thence N45°30'50"W 161.01 feet to a point on the Southeast right-of-way line of Midland Drive; thence N44°29'10"E 108.29 feet along the Southeast right-of-way line of Midland Drive to the Point of Beginning.

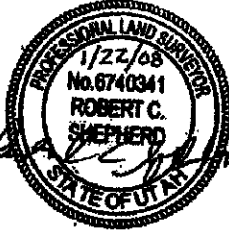

Prepared by Robert C. Shepherd

Approved:

Val Surrag 1-23-2008
Val Surrag, Manager,
Taylor-West Weber Water Improvement District

_____ Date

Public Notary Seal

County of Weber)

On this 23 day of January in the year 2008, before me Shelley P. Hadley
a notary public, personally appeared Val Surrage
NAME OF DOCUMENT SIGNER

proved on the basis of satisfactory evidence to be the person(s) whose name(s) (is/are) subscribed to this instrument, and acknowledged (he/she/they) executed the same. Witness my hand and official seal.

Shelley P. Hadley
NOTARY PUBLIC

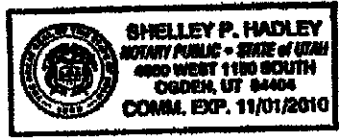

S
E
A
L

Taylor West Weber Water Improvement District

Map Of Currently Served Areas To Be Annexed Into The District

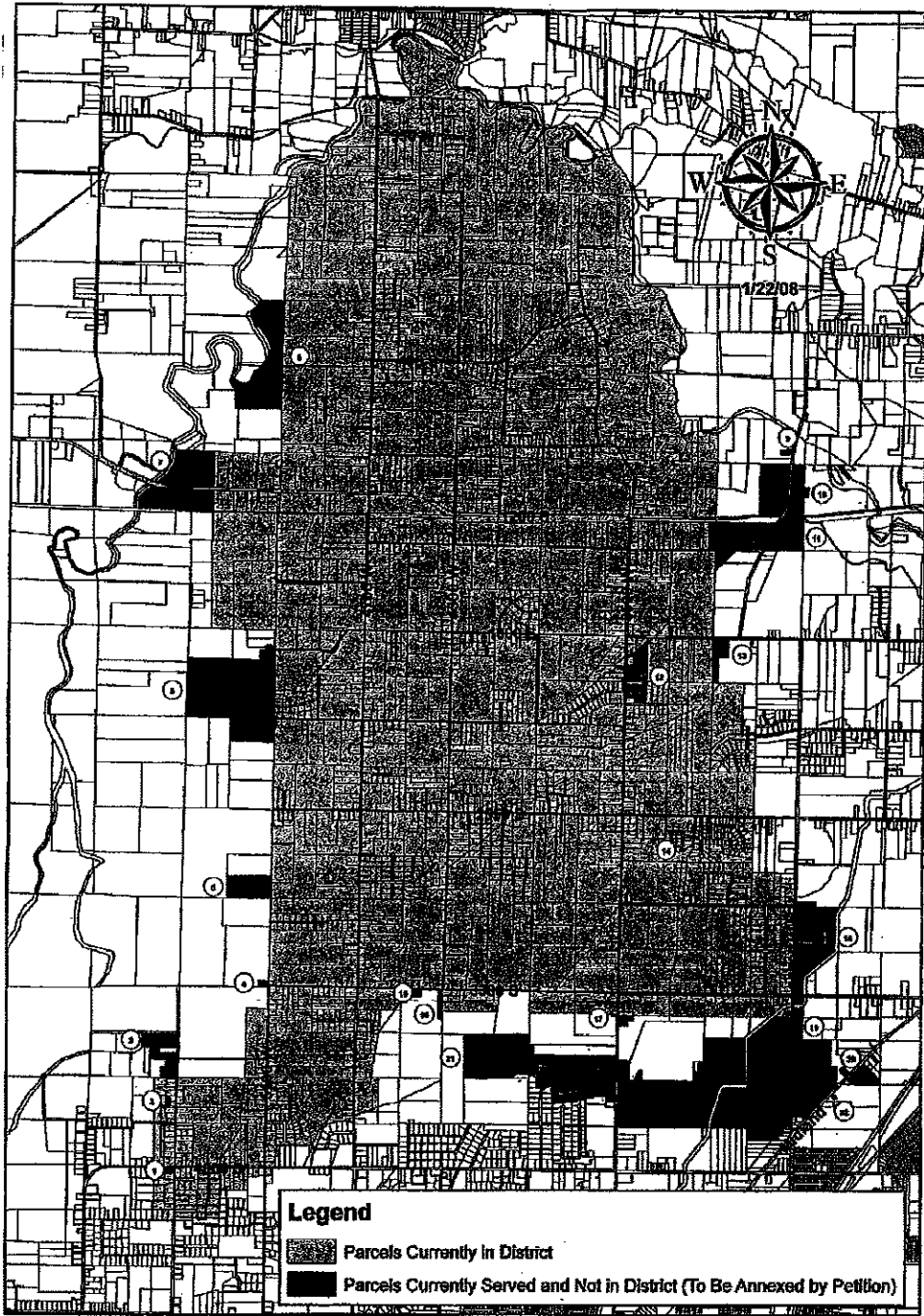

FR 2519049 PG 11 OF 11
Taylor West Weber Water Improvement District
Map Of Currently Served Areas To Be Annexed Into The District

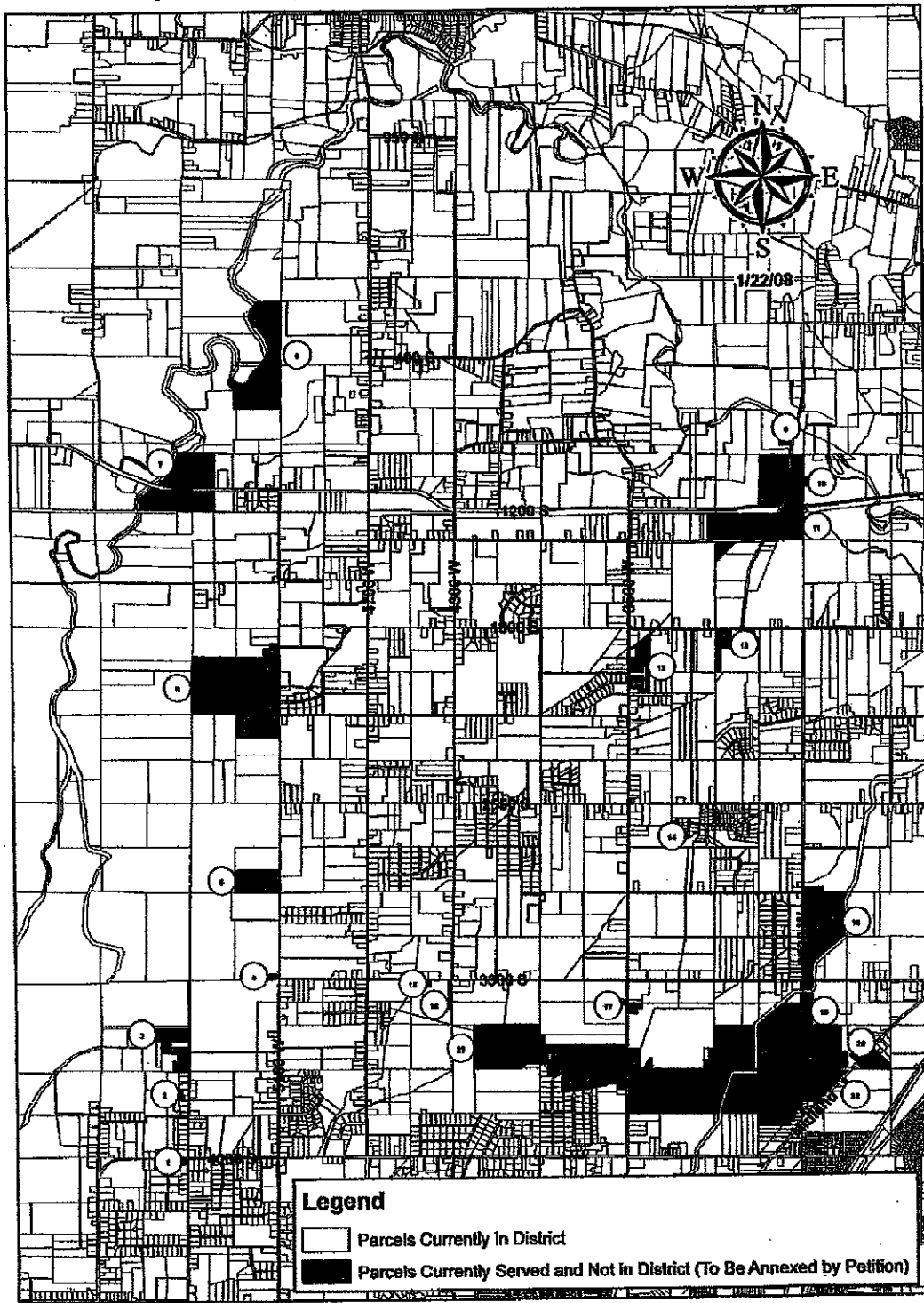

Taylor West Weber Water Improvement District

Map Of Currently Served Areas To Be Annexed Into The District

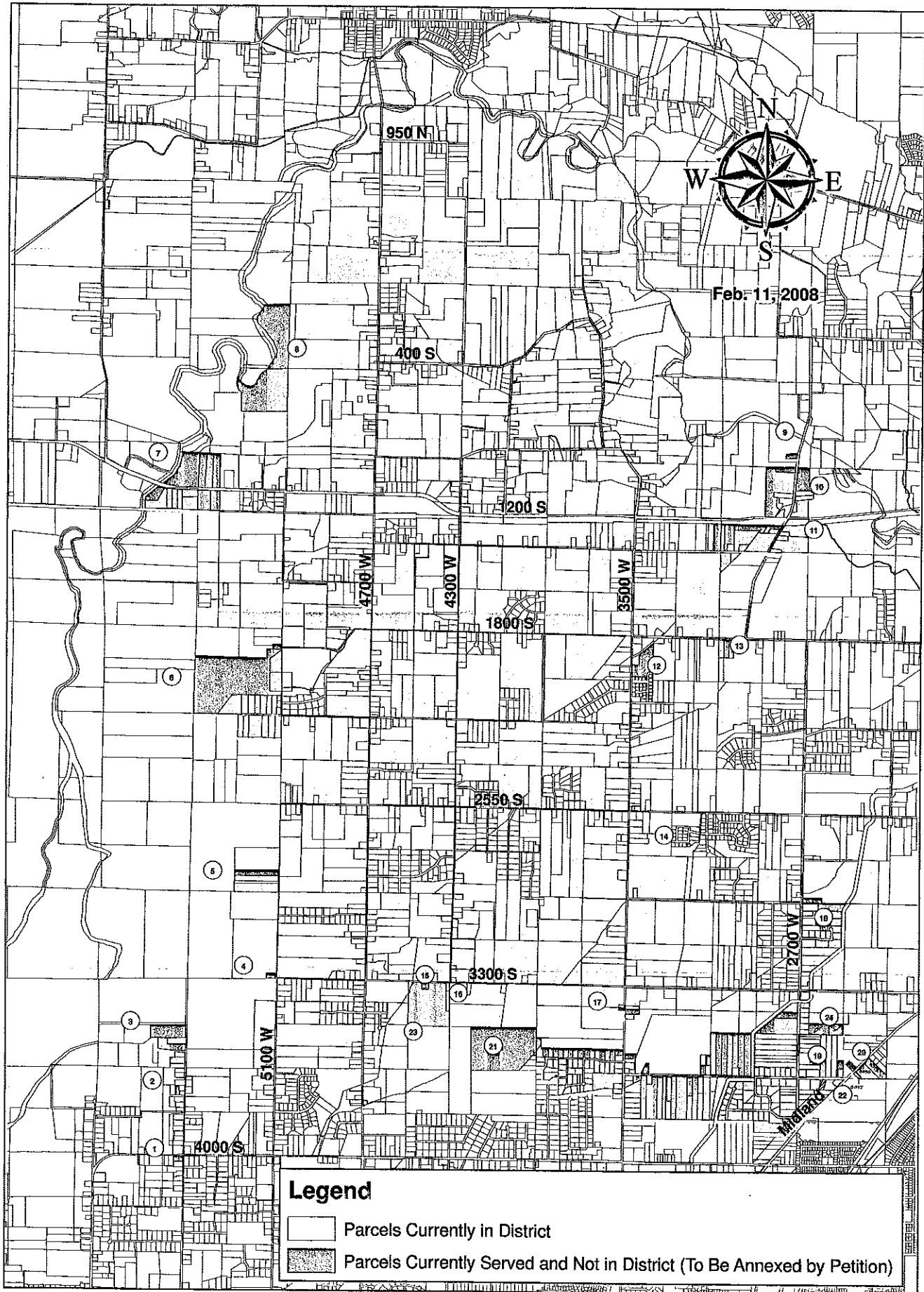



W2336208

E# 2336208 PG 1 OF 10
ERNEST D ROWLEY, WEBER COUNTY RECORDER
21-APR-08 404 PM FEE \$1.00 DEP SPY
REC FOR: TAYLOR WEST WEBER WATER IMPROV

**TAYLOR WEST WEBER WATER IMPROVEMENT
DISTRICT
4660 WEST 1150 SOUTH
OGDEN, UTAH 84404**

Narration: This document is intended as a correction to a document of the same format, notarized on January 23rd, 2008, and recorded in the Weber County Recorder's Office on January 28th, 2008 as entry #2318044. Said previous document describes annexation areas numbered 1 through 22. During the process of mapping the previously recorded document, typographical errors were discovered in the legal descriptions recorded on said entry, and are herein corrected. Two additional areas, numbered 23 and 24, are also being included in this resubmission.

Taylor West Weber Water Improvement District (the "District") desires to have all of the parcels to which it serves culinary water officially recognized by Weber County, Utah (the "County") as being within the District. It is the intent of the District that all parcels within the described areas on the attached sheets and visually represented in the attached map, "Taylor West Weber Water District" be included on the County's official records as being part of the District, taxable by the County for the District, according to applicable law.

Area 1 (Completely within Hooper City)

A parcel of land in the Northwest 1/4 of Section 7, T5N, R2W, Salt Lake Base and Meridian, Weber County, Utah, described as having a POINT OF BEGINNING being S00°40'E 70.00 feet along the N-S 1/4 line of said Section 7, from the North 1/4 corner of said Section 7; thence continuing S00°40'E 150.00 feet along the N-S 1/4 line of said Section 7; thence S89°20'W 290.00 feet; thence N00°40'W 149.54 feet; thence N89°14'30"E 290.00 feet to the Point of Beginning.

Area 2 (Completely within Hooper City)

A parcel of land in the Southwest 1/4 of Section 6, T5N, R2W, Salt Lake Base and Meridian, Weber County, Utah, being the South 301.01 feet of Lot 3 of "Westland Subdivision", a subdivision as recorded in Book 47 on Page 087 of Weber County Records.

Q:\T\WWW\ID\Word Docs\Annexation docs\archive\2008-0-21 legal description of areas served_to be annexed.doc

Received

MAY 01 2008

Gary R. Herbert
Lieutenant Governor

Area 3 (Completely within Hooper City)

All of Lot 1 of "Mosquito Ranch Subdivision" as recorded in Book 42 on Page 077 of Weber County Records, all of Lot 1B of a Division of "Jolly Ranch Estate Subdivision" as recorded in Book 32 on Page 014 of Weber County Records, all of Lot 1 and all of Lot 3 of "Stoddard and Finster Subdivision" as recorded in Book 52 on Page 088 of Weber County Records, being subdivisions of part of the Northwest 1/4 of Section 6, T5N, R2W, Salt Lake Base and Meridian, Weber County, Utah; also the following described parcel: having a POINT OF BEGINNING being the Northeast corner of Lot 1 of said "Stoddard and Finster Subdivision"; thence North along the West right-of-way line of 5500 West Street 151.00 feet; thence N85°56'21"W 300.50 feet; thence S00°44'58"W 167.06 feet; thence S89°00'11"E 300.00 feet to the Point of Beginning.

Area 4 (Completely within Hooper City)

A parcel of land in the Southeast 1/4 of Section 31, T6N, R2W, Salt Lake Base and Meridian, Weber County, Utah, being all of Lot 1 of "Gooch Subdivision", a subdivision as recorded in Book 36 on Page 010 of Weber County Records.

Area 5 (Completely within unincorporated Weber County)

A parcel of land in the Northeast 1/4 of Section 31, T6N, R2W, Salt Lake Base and Meridian, Weber County, Utah, being the South 660.00 feet of the Southeast 1/4 of the Northeast 1/4 of said Section 31.

Area 6 (Completely within unincorporated Weber County)

A parcel of land in the East 1/2 of Section 30, T6N, R2W, Salt Lake Base and Meridian, Weber County, Utah, described as having a POINT OF BEGINNING being S00°41'31"W 473.29 feet along the East line of said Section 30, from the Northeast corner of said Section 30; thence continuing S00°41'31"W 2181.03 feet along the East line of said Section 30 to the East 1/4 corner of said Section 30; thence S00°43'08"W 660.00 feet along the East line of said Section 30; thence N89°16'52"W 1320.00 feet; thence N00°43'08"E 660.00 feet; thence N89°16'52"W 1274.56 feet; thence N01°00'00"E 1770.26 feet; thence S88°28'00"E 664.00 feet; thence S01°32'00"W 10.00 feet; thence S88°28'00"E 17.00 feet; thence N01°32'00"E 10.00 feet; thence S88°28'00"E 113.00 feet; thence S88°15'00"E 472.00 feet; thence S88°56'00"E 824.63 feet; thence N00°41'31"E 274.27 feet; thence S89°25'52"E 177.55 feet; thence N00°41'31"E 160.01 feet; thence S89°25'52"E 317.05 feet to the Point of Beginning

Area 7 (Completely within unincorporated Weber County)

A parcel of land in the North 1/2 of Section 19, T6N, R2W, Salt Lake Base and Meridian, Weber County, Utah, described as having a POINT OF BEGINNING being N86°44'10"W 1980.00 feet along the North line of said Section 19, from the Northeast corner of said Section 19; thence S01°30'15"W 1870.01 feet; thence N89°14'49"W 1105.26 feet; thence N00°45'11"E 90.00 feet; thence N89°14'51"W 1190.16 feet; thence N02°30'50"E 326.57 feet to a point on the centerline of the Weber River; thence the following six courses along the centerline of the Weber River: (1)N50°26'19"E 509.87 feet, (2)N47°00'36"E 97.11 feet, (3)N52°55'00"E 400.00 feet, (4)N39°23'45"E 335.34 feet, (5)N20°39'09"E 316.32 feet, and (6)N05°57'37"E 305.16 feet to a point of intersection of the centerline of the Weber River with the North line of said Section 19; thence S86°44'10"E 1191.43 feet along the North line of said Section 19 to the Point of Beginning.

Area 8(Completely within unincorporated Weber County)

A parcel of land in part of the East 1/2 of Section 18, T6N, R2W, Salt Lake Base and Meridian, Weber County, Utah, described as having a POINT OF BEGINNING being the East 1/4 corner of said Section 18; thence South 1320.00 feet along the East line of said Section 18; thence West 1402.50 feet; thence North 1320.00 feet to a point on the E-W 1/4 line of said Section 18; thence East along the E-W 1/4 line to a point on the centerline of the Weber River; thence Southerly, Easterly, and Northerly along the centerline of the Weber River to a point which is 1963.50 feet North of the E-W 1/4 line of said Section 18; thence East 792.00 feet to a point on the East line of said Section 18; thence South 1963.50 feet along the East line of said Section 18 to the Point of Beginning.

Area 9 (Completely within unincorporated Weber County)

A parcel of land in part of the Southeast 1/4 of Section 15, T6N, R2W, Salt Lake Base and Meridian, Weber County, Utah, described as having a POINT OF BEGINNING being on the West right-of-way line of 2700 West, said point being 117.20 feet North and Northeasterly 150.00 feet along the West right-of-way line of 2700 West from the intersection of the South line of said Section 15 and the West right-of-way line of 2700 West; thence West 290.00 feet; thence North 150.00 feet; thence East to the West right-of-way line of 2700 West; thence Southwesterly along the West right-of-way line of 2700 West to the Point of Beginning.

Area 10 and 11 (Completely within unincorporated Weber County)

A parcel of land in parts of Section 22 and Section 23, T6N, R2W, Salt Lake Base and Meridian, Weber County, Utah, described as having a POINT OF BEGINNING being the Northeast corner of said Section 22; thence S00°41'10"W 723.71 feet along the section line between Section 22 and Section 23; thence N86°03'39"E 152.28 feet; thence S04°52'40"W 304.15 feet; thence S86°03'39"W 129.98 feet; thence S00°41'10"W 1611.03 feet along the section line between Section 22 and Section 23; thence N89°09'34"W 800.11 feet along the E-W 1/4 of said Section 22; thence South 22.52 feet; thence N88°53'06"W 386.67 feet to a point on the East right-of-way line of 2900 West; thence N29°16'16"E 23.50 feet along the East right-of-way line of 2900 West; thence N89°09'34"W 799.96 feet along the E-W 1/4 line of said Section 22 to a point on the centerline of a canal; thence Southwesterly along the centerline of a canal the following three courses: (1)S46°20'26"W 505.78 feet, (2)S44°35'26"W 196.50 feet, and (3)S43°15'26"W 249.97 feet; thence N00°47'26"E 680.99 feet to the Center Corner of said Section 22; thence N89°09'34"W 218.40 feet along the E-W 1/4 line of said Section 22; thence N00°43'39"E 805.01 feet to a point on the South right-of-way line of the Southern Pacific Railroad; thence S89°14'16"E 2123.17 feet along the South right-of-way line of the Southern Pacific Railroad to a point on the East right-of-way line of 2900 West; thence N29°16'16"E 345.61 feet along the East right-of-way line of 2900 West to a point on the North right-of-way line of 1200 South; thence N89°13'06"W 731.46 feet along the North right-of-way line of 1200 South; thence North 1521.47 feet to a point on the North line of said Section 22; thence S89°19'39"E 1320.00 feet along the North line of said Section 22 to the Point of Beginning.

Area 12 (Completely within unincorporated Weber County)

All of "Wally's Acre Cluster Subdivision 3", a subdivision of part of the Northwest 1/4 of Section 27, T6N, R2W, Salt Lake Base and Meridian, Weber County, Utah, as recorded in Book 65 on Page 091 of Weber County Records.

Area 13 (Completely within West Haven City)

A parcel of land in the Northeast 1/4 of Section 27, T6N, R2W, Salt Lake Base and Meridian, Weber County, Utah, described as having a POINT OF BEGINNING being the North 1/4 corner of said Section 27; thence East 453.00 feet along the North line of said Section 27, thence South 578.00 feet; thence West 300.00 feet; thence South 742.00 feet; thence West 153.00 feet; thence North 1320.00 feet along the N-S 1/4 line of said Section 27 to the Point of Beginning.

Area 14 (Completely within West Haven City)

Lot 71 "Windsor Farms Subdivision Phase 2", a subdivision of part of the Northwest 1/4 of Section 34, T6N, R2W, Salt Lake Base and Meridian, Weber County, Utah, as recorded in Book 62 on Page 014 of Weber County Records.

Area 15 (Completely within unincorporated Weber County)

Lot 1 "Favero Subdivision", a subdivision of part of the Northeast 1/4 of Section 5, T5N, R2W, Salt Lake Base and Meridian, Weber County, Utah, as recorded in Book 45 on Page 001 of Weber County Records.

Area 16 (Completely within unincorporated Weber County)

A parcel of land in part of the Northeast 1/4 of Section 5, T5N, R2W, Salt Lake Base and Meridian, Weber County, Utah, described as having a POINT OF BEGINNING being East 2480.00 feet along the North line of said Section 5 from the North 1/4 corner of said Section 5 and South 33.00 feet to a point on the South right-of-way line of 3300 South; thence East 103.50 feet along the South right-of-way line of 3300 South; thence South 841.75 feet; thence West 103.50 feet; thence North 841.75 feet to the Point of Beginning.

Area 17 (Completely within unincorporated Weber County)

A parcel of land in part of the Northeast 1/4 of Section 4 and the Northwest 1/4 of Section 3, T5N, R2W, Salt Lake Base and Meridian, Weber County, Utah, described as having a POINT OF BEGINNING being N00°53'10"E 1679.74 feet along the line between said Section 3 and said Section 4 from the 1/4 corner between said Sections 3 and 4; thence continuing along said line N00°53'10"E 234.75 feet; thence N89°06'50"W 200.00 feet; thence N00°53'10"E 72.00 feet; thence S89°06'50"E 200.00 feet; thence S89°13'53"E 429.00 feet; thence S00°53'10"W 156.75 feet; thence N89°13'53"W 122.00 feet; thence S00°53'10"W 150.00 feet; thence N89°13'53"W 307.00 feet to the Point of Beginning.

Area 18 (Completely within West Haven City)

A parcel of land in part of the West 1/2 of Section 35, T6N, R2W, Salt Lake Base and Meridian, and in part of the Northwest 1/4 of Section 2, T5N, R2W, Salt Lake Base and Meridian, described as having a POINT OF BEGINNING being the Southwest corner of said Section 35; thence N00°54'04"E 2653.97 feet along the West line of said Section 35 to the West 1/4 corner of said Section 35; thence N00°43'06"E 150.00 feet along the West line of said Section 35; thence S89°21'42"E 604.80 feet; thence South 150.01 feet to a point on the E-W 1/4 line of said Section 35; thence S89°21'42"E 688.23 feet along the E-W 1/4 of said Section 35 to a point on the Westerly line of the Layton Canal; thence along the Westerly line of the Layton Canal the following ten courses:

(1)S36°16'48"W 56.12 feet, (2)154.97 feet along the arc of a curve to the left that has a radius of 250.00 feet and is subtended by a long chord with a bearing of S18°31'18"W and a length of 152.50 feet, (3)S00°45'47"W 1079.53 feet, (4)87.60 feet along the arc of a curve to the right that has a radius of 100.00 feet and is subtended by a long chord with a bearing of S25°51'32"W and a length of 84.83 feet, (5)S50°57'17"W 1087.44 feet, (6)130.63 feet along the arc of a curve to the left that has a radius of 150.00 feet and is subtended by a long chord with a bearing of S26°00'21"W and a length of 126.54 feet, (7)S01°03'25"W 499.40 feet, (8)S01°31'06"W 178.54 feet, (9) 164.49 feet along the arc of a curve to the right that has a radius of 105.00 feet and is subtended by a long chord with a bearing of S46°23'53"W and a length of 148.18 feet, and (10)N88°43'20"W 186.52 feet to a point on the West line of said Section 2; thence N00°51'40"E 281.00 feet along the West line of said Section 2 to the Point of Beginning.

Area 19 (Completely within West Haven City)

A parcel of land in part of the East 1/2 of Section 3, T5N, R2W, Salt Lake Base and Meridian, and in part of the West 1/2 of Section 2, T5N, R2W, Salt Lake Base and Meridian, described as having a POINT OF BEGINNING being S00°51'40"W 369.25 feet along the East line of said Section 3 from the Northeast corner of said Section 3 to a point on the South line of the Layton Canal; thence the following three courses along said line of the Layton Canal: (1)S89°12'02"E 173.38 feet, (2)116.09 feet along the arc of a curve to the left that has a radius of 269.54 feet and is subtended by a long chord with a bearing of N78°59'04"E and a length of 115.20 feet, and (3)N52°03'37"E 37.22 feet; thence S00°51'40"W 338.30 feet; thence N89°06'16"W 15.12 feet; thence S00°51'40"W 303.65 feet; thence S89°06'16"E 4.00 feet; thence S00°51'40"W 330.00 feet; thence S88°58'51"E 861.01 feet; thence S00°51'40"W 820.21 feet; thence S89°11'46"E 198.30 feet; thence S00°41'43"W 532.34 feet to a point on the E-W 1/4 line of said Section 2; thence S88°58'51"E 14.51 feet along the E-W 1/4 line of said Section 2 to a point on the Northwest right-of-way line of Midland Drive; thence S44°28'33"W 1444.34 feet along the Northwest right-of-way line of Midland Drive; thence North 87.63 feet; thence N89°11'25"W 381.69 feet to a point on the East line of said Section 3; thence S00°51'40"W 270.03 feet along the East line of said Section 3; thence N89°23'55"W 183.00 feet; thence S00°51'40"W 10.00 feet; thence N89°23'55"W 44.00 feet; thence S00°44'58"W 297.33 feet; thence N89°35'55"W 161.94 feet; thence S00°41'19"W 127.57 feet; thence N89°42'13"W 927.49 feet; thence N00°09'29"E 361.21 feet; thence N89°23'55"W 769.00 feet; thence South 5.93 feet; thence N89°54'31"W 317.94 feet; thence N08°06'24"E 300.10 feet to a point on the Easterly line of the Layton Canal; thence along the Easterly line of the Layton Canal the following six courses: (1)N19°06'24"E 896.34 feet, (2)62.50 feet along the arc of a curve to the right that has a radius of 50.00 feet and is subtended by a long chord with a bearing of N54°54'59"E and a length of 58.51 feet, (3)S89°16'25"E 720.78 feet, (4)N00°51'35"E 1429.02 feet, (5)87.02 feet along the arc of a curve to the right that has a radius of 100.00 feet and is subtended by a long chord with a bearing of N25°47'18"E and a length of 84.30 feet, and (6)N50°43'00"E 706.45 feet; thence S87°43'53"E 744.70 feet to a point on the East line of said Section 3; thence N00°51'40"E 479.15 feet along the East line of said Section 3 to the Point of Beginning.

Area 20 (Completely within West Haven City)

A parcel of land in part of the Northwest 1/4 of Section 2, T5N, R2W, Salt Lake Base and Meridian, Weber County, Utah, described as having a POINT OF BEGINNING being S88°29'17"E 1744.01 feet along the E-W 1/4 line of said Section 2 from the West 1/4 corner of said Section 2; thence N45°27'30"W 177.34 feet to a point on the SE line of Midland Drive; thence N44°32'30"E 68.85 feet along the said SE line; thence N45°27'30"W 356.40 feet; thence N44°32'30"E 150.00 feet; thence S45°27'30"E 356.40 feet to a point on the said SE line; thence N44°32'30"E 481.89 feet along the said SE line; thence S45°27'30"E 737.60 feet; thence S00°17'30"E 130.00 feet along the N-S 1/4 line of said Section 2; thence N88°29'17"W 891.81 feet along the E-W 1/4 line of said Section 2 to the Point of Beginning.

Area 21 (Completely within West Haven City)

A parcel of land in part of Section 3, T5N, R2W, Salt Lake Base and Meridian and in part of Section 4, T5N, R2W, Salt Lake Base and Meridian, Weber County, Utah, described as having a POINT OF BEGINNING being S00°53'10"W 1923.32 feet from the Northwest corner of said Section 3; thence S89°15'20"E 363.00 feet; thence S00°53'10"W 629.18 feet to a point on the E-W 1/4 line of said Section 3; thence S89°15'20"E 257.06 feet along the E-W 1/4 line of said Section 3; thence North 33.00 feet; thence N33°59'40"E 171.63 feet; thence N30°45'59"E 137.06 feet; thence S89°15'20"E 87.32 feet; thence S00°44'40"W 295.20 feet to a point on the E-W 1/4 line of said Section 3; thence S89°15'20"E 1470.57 feet along the E-W 1/4 line of said Section 3; thence N00°49'58"E 323.40 feet; thence S89°15'20"E 150.00 feet, thence N00°36'56"E 309.60 feet; thence S89°15'20"E 150.00 feet; thence N00°43'35"E 687.00 feet; thence S89°16'25"E 1224.59 feet to a point on the Westerly line of the Layton Canal; thence along the westerly line of the Layton Canal the following two courses, (1)33.92 feet along the arc of a curve to the left that has a radius of 200.00 feet and is subtended by a long chord with a bearing of S05°43'05"W and a length of 33.88 feet and (2)S00°51'35"W 1286.26 feet to a point on the E-W 1/4 line of said Section 3; thence N89°16'25"W 621.12 feet along the E-W 1/4 line of said Section 3; thence S00°43'35"W 33.00 feet to a point on the West line of the Layton Canal; thence along the westerly line of the Layton Canal the following five courses, (1)200.00 feet along the arc of a curve to the left that has a radius of 160.00 feet and is subtended by a long chord with a bearing of S54°55'00"W and a length of 187.23 feet, (2)S70°53'36"E 10.00 feet, (3)S19°06'24"W 965.70 feet, (4)36.40 feet along the arc of a curve to the left that has a radius of 200.00 feet and is subtended by a long chord with a bearing of S13°36'24"W and a length of 38.34 feet, and (5)S08°06'24"W 228.96 feet; thence N89°20'54"W 2751.19 feet to a point on the Section line between said Section 3 and said Section 4; thence N00°47'15"E 719.00 feet along the Section line between said Section 3 and said Section 4; thence West 310.00 feet; thence North 150.00 feet; thence West 161.63 feet; thence S82°39'38"W 1529.52 feet; thence N00°44'26"E 557.17 feet; thence N89°06'02"W 10.92 feet; thence 314.31 feet along the arc of a curve to the left that has a radius of 330.11 feet and is subtended by a long chord with a bearing of S63°37'19"W and a length of 302.57 feet; thence N53°39'18"W 30.00 feet; thence N89°17'29"W 125.67 feet; thence N00°44'02"E 341.22 feet; thence 124.31 feet along the arc of a curve to the right that has a radius of 50.00 feet and is subtended by a long chord with a bearing of N55°03'23"W and a length of 94.68 feet; thence N89°17'40"W 519.64 feet; thence S36°35'41"W 184.45 feet; thence West 1505.63 feet; thence North 1320.00 feet; thence East 1980.00 feet; thence S00°40'38"W 297.02 feet; thence East 156.04 feet; thence S00°24'08"W 296.99 feet; thence S89°06'04"E 2508.00 feet to the Point of Beginning.

Area 22 (Completely within West Haven City)

A parcel of land part of the Southwest 1/4 of Section 2, T5N, R2W, Salt Lake Base and Meridian, Weber County, Utah, described as having a POINT OF BEGINNING being S89°14'41"E 1501.86 feet along the E-W 1/4 line of said Section 2 to a point on the Southeast right-of-way line of Midland Drive and S44°29'10"W 398.94 feet along the Southeast right-of-way line of Midland Drive from the West 1/4 corner of said Section 2; thence S45°30'50"E 161.01 feet; thence S44°29'10"W 108.29 feet; thence N45°30'50"W 161.01 feet to a point on the Southeast right-of-way line of Midland Drive; thence N44°29'10"E 108.29 feet along the Southeast right-of-way line of Midland Drive to the Point of Beginning.

Area 23 (Completely within West Haven City)

A parcel of land in the Northeast 1/4 of Section 5, T5N, R2W, Salt Lake Base and Meridian, U.S. survey, beginning 1436.5 feet East from the Northwest corner of said 1/4 Section, and running thence East 1200 feet; thence South 874.75 feet; thence East 103.5 feet; thence South 461.75 feet; thence West 1267 feet; thence North 1336.5 feet to the Point of Beginning.

Excepting there from: A parcel of land in the Northeast 1/4 of Section 5, T5N, R2W, Salt Lake Base and Meridian, U.S. survey, described as follows: beginning at a point on the centerline of 3300 south street, said point being N88d34'02"W 652.90 feet from the Northeast corner of said section 5; thence S01d25'58"W 240.00feet; thence N88d34'02"W 200.00 feet; thence N01d25'58"E 240.00 feet to said centerline; thence S88d34'02"E along said centerline 200.00 feet to the Point of Beginning.

Area 24 (Completely within West Haven City)

A parcel of land being part of lot 4 of the Northwest 1/4 of Section 2, T5N, R2W, Salt Lake Base and Meridian, U.S. survey, beginning at a point on the South line of said lot 4, 304 feet east from the southwest corner and running thence North 330 feet; thence East 1016 feet, more or less, to the East line of lot 4; thence South 330 feet to the South line of lot 4; thence West 1016 feet, more or less, to the Point of Beginning.

Prepared by Robert C. Shepherd

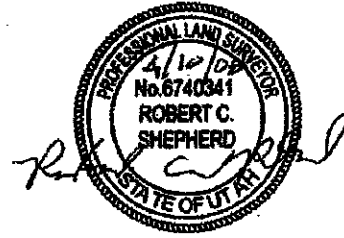

Approved:

Val Surrage
Val Surrage, Manager,
Taylor-West Weber Water Improvement District

4-14-2008
Date

ACKNOWLEDGEMENT

State of Utah)
 §
County of Weber)

On this 14 day of April, 2008, before me, Shelley P Hadley, a notary public, personally appeared Val Surrage, proved on the basis of satisfactory evidence to be the person whose name is subscribed to this instrument, and acknowledged he executed the same. Witness my hand and official seal.

Public Notary Seal

Shelley P. Hadley
Notary Public





W2336206

TAYLOR WEST WEBER WATER IMPROVEMENT DISTRICT

4660 WEST 1150 SOUTH
OGDEN, UTAH 84404

EN 2336206 PG 1 OF 1
ERNEST D ROWLEY, WEBER COUNTY RECORDER
21-APR-08 404 PM FEE \$1.00 DEP 5PY
REC FOR: TAYLOR WEST WEBER WATER IMPROV

Narration:

This document is to withdraw the below-described area from the Taylor-West Weber Water Improvement District. This area was submitted for annexation into the District on Page 7 of recorded entry #2330458 in the office of the Weber County Recorder, and has subsequently been determined to be an erroneous description. The area was named Area 24 on the previously recorded document and is therefore named Area 24 in this document.

Area 24 (Completely within West Haven City)

A parcel of land in part of lot 4 of the Northwest 1/4 of Section 1, T5N, R2W, Salt Lake Base and Meridian, U.S. survey, beginning at a point on the South line of said lot 4, 304 feet east from the southwest corner and running thence North 330 feet; thence East 1016 feet, more or less, to the East line of lot 4; thence South 330 feet to the South line of lot 4; thence West 1016 feet, more or less, to the Point of Beginning.

Val Surrage

Val Surrage, Manager,
Taylor-West Weber Water Improvement District

4-14-2008

Date

ACKNOWLEDGEMENT

State of Utah)

§

County of Weber)

On this 14 day of April, 2008, before me, Shelley P Hadley, a notary public, personally appeared Val Surrage, proved on the basis of satisfactory evidence to be the person whose name is subscribed to this instrument, and acknowledged he executed the same. Witness my hand and official seal.

Shelley P. Hadley
Notary Public

Public Notary Seal



Q:\TWWW\ID\Word Docs\Annexation docs\03-26-08 TWWW withdrawal of area 20.doc

Received

MAY 01 2008

Gary R. Herbert
Lieutenant Governor



"W2336207"

EN 2336207 PG 1 OF 1
ERNEST D ROWLEY, WEBER COUNTY RECORDER
21-APR-08 404 PM FEE \$1.00 DEP SPY
REC FOR: TAYLOR WEST WEBER WATER IMPROV

**TAYLOR WEST WEBER WATER IMPROVEMENT DISTRICT
4660 WEST 1150 SOUTH
OGDEN, UTAH 84404**

Taylor West Weber Water Improvement District (the "District") desires to have all of the parcels to which it serves culinary water officially recognized by Weber County, Utah (the "County") as being within the District. It is the intent of the District that all parcels within the described area on this sheet be included on the County's official records as being part of the District, taxable by the County for the District, according to applicable law.

Area 24 (Completely within West Haven City)

A parcel of land being part of lot 4 of the Northwest 1/4 of Section 2, T5N, R2W, Salt Lake Base and Meridian, U.S. survey, beginning at a point on the South line of said lot 4, 304 feet east from the southwest corner and running thence North 330 feet; thence East 1016 feet, more or less, to the East line of lot 4; thence South 330 feet to the South line of lot 4; thence West 1016 feet, more or less, to the Point of Beginning.

Prepared by Robert C. Shepherd

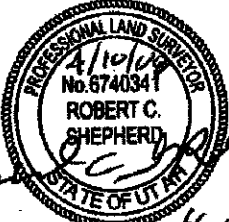
Robert C. Shepherd
Date 4-14-2008

Approved:

Val Surrage
Val Surrage, Manager,
Taylor-West Weber Water Improvement District

ACKNOWLEDGEMENT

State of Utah)
 §
County of Weber)

On this 14 day of April, 2008, before me, Shelley P Hadley, a notary public, personally appeared Val Surrage, proved on the basis of satisfactory evidence to be the person whose name is subscribed to this instrument, and acknowledged he executed the same. Witness my hand and official seal.

Public Notary Seal

SHELLEY P. HADLEY
NOTARY PUBLIC - STATE OF UTAH
4660 WEST 1150 SOUTH
OGDEN, UT 84404
COMM. EXP. 11/01/2010

Shelley P. Hadley
Notary Public

Received

MAY 01 2008

Gary R. Herbert
Lieutenant Governor



W2336205

TAYLOR WEST WEBER WATER IMPROVEMENT DISTRICT

4660 WEST 1150 SOUTH
OGDEN, UTAH 84404

EB 2336205 PG 1 OF 1
ERNEST D ROWLEY, WEBER COUNTY RECORDER
21-APR-08 403 PM FEE \$5.00 DEP SPY
REC FOR: TAYLOR WEST WEBER WATER IMPROV

Taylor West Weber Water Improvement District (the "District") desires to have all of the parcels to which it serves culinary water officially recognized by Weber County, Utah (the "County") as being within the District. It is the intent of the District that all parcels within the described area on this sheet be included on the County's official records as being part of the District, taxable by the County for the District, according to applicable law

Area 20 (Completely within West Haven City)

A parcel of land in part of the Northwest 1/4 of Section 2, T5N, R2W, Salt Lake Base and Meridian, Weber County, Utah, described as having a POINT OF BEGINNING being S88°29'17"E 1744.01 feet along the E-W 1/4 line of said Section 2 from the West 1/4 corner of said Section 2; thence N45°27'30"W 177.34 feet to a point on the SE line of Midland Drive; thence N44°32'30"E 68.85 feet along the said SE line; thence N45°27'30"W 356.40 feet; thence N44°32'30"E 150.00 feet; thence S45°27'30"E 356.40 feet to a point on the said SE line; thence N44°32'30"E 481.89 feet along the said SE line; thence S45°27'30"E 737.60 feet; thence S00°17'30"E 130.00 feet along the N-S 1/4 line of said Section 2; thence N88°29'17"W 891.81 feet along the E-W 1/4 line of said Section 2 to the Point of Beginning.

Prepared by Robert C. Shepherd

Approved:

Val Surrage
Val Surrage, Manager,
Taylor-West Weber Water Improvement District

PROFESSIONAL LAND SURVEYOR
No. 6740341
ROBERT C. SHEPHERD
Date

ACKNOWLEDGEMENT

State of Utah)

§

County of Weber)

On this 14 day of April, 2008, before me, Shelley P Hadley, a notary public, personally appeared Val Surrage, proved on the basis of satisfactory evidence to be the person whose name is subscribed to this instrument, and acknowledged he executed the same. Witness my hand and official seal.

Public Notary Seal

SHELLEY P. HADLEY
NOTARY PUBLIC • STATE OF UTAH
4660 WEST 1150 SOUTH
OGDEN, UT 84404
COMM. EXP. 11/01/2010

Shelley P. Hadley
Notary Public

Received

MAY 01 2008

Gary E. Herbert
Lieutenant Governor



"W2330457"

EH 2330457 PG 1 OF 1
ERNEST D ROWLEY, WEBER COUNTY RECORDER
26-MAR-08 1136 AM FEE \$1.00 DEP SPY
REC FOR: TAYLOR WEST WEBER WATER DIST

**TAYLOR WEST WEBER WATER IMPROVEMENT
DISTRICT
4660 WEST 1150 SOUTH
OGDEN, UTAH 84404**

Narration:

This document is to withdraw the below-described area from the Taylor-West Weber Water Improvement District. This area was submitted for annexation into the District on Page 6 of recorded entry #2318044 in the office of the Weber County Recorder, and has subsequently been determined to be an erroneous description. The area was named Area 20 on the previously recorded document and is therefore named Area 20 in this document.

T- 08-028-0050, 0017, 0034, 0012
= A.

Area 20 (Completely within West Haven City)

A parcel of land in part of the Northwest 1/4 of Section 2, T5N, R2W, Salt Lake Base and Meridian, Weber County, Utah, described as having a POINT OF BEGINNING being S88°29'17"E 1744.01 feet along the E-W 1/4 line of said Section 2 from the West 1/4 corner of said Section 2; thence N45°27'30"W 177.34 feet to a point on the SE line of Midland Drive; thence N44°32'30"E 68.85 feet along the said SE line; thence N45°27'30"W 356.40 feet; thence N44°32'30"E 150.00 feet; thence S45°27'30"E 356.40 feet to a point on the said SE line; thence N44°32'30"E 481.89 feet along the said SE line; thence S45°27'30"E 737.60 feet; thence S00°17'30"E 130.00 feet along the N-S 1/4 line of said Section 2; thence N88°29'17"W 891.81 feet along the E-W 1/4 line of said Section 2 to the Point of Beginning.

Val Surrage
Val Surrage, Manager,
Taylor-West Weber Water Improvement District

3-26-2008
Date

ACKNOWLEDGEMENT

State of Utah)
 §
County of Weber)

On this 26 day of March, 2008, before me, Shelley P Hadley, a notary public, personally appeared Val Surrage, proved on the basis of satisfactory evidence to be the person whose name is subscribed to this instrument, and acknowledged he executed the same. Witness my hand and official seal.

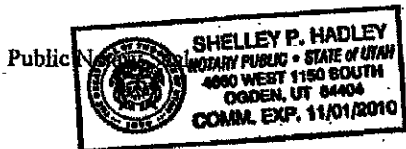

Shelley P. Hadley
Notary Public

Q:\T\WWW\Word Docs\Annexation docs\03-26-08 TWWW withdrawal of area 20.doc

Received

MAY 01 2008

9



"W2336204"

TAYLOR WEST WEBER WATER IMPROVEMENT DISTRICT

4660 WEST 1150 SOUTH
OGDEN, UTAH 84404

EN 2336204 PG 1 OF 1
ERNEST D ROWLEY, WEBER COUNTY RECORDER
21-APR-08 403 PM FEE \$1.00 DEP SPY
REC FOR: TAYLOR WEST WEBER WATER IMPROV

Narration:

This document is to withdraw the below-described area from the Taylor-West Weber Water Improvement District. This area was submitted for annexation into the District on Page 6 of recorded entry #2318044 in the office of the Weber County Recorder, and has subsequently been determined to be an erroneous description. The area was named Area 20 on the previously recorded document and is therefore named Area 20 in this document.

Area 20 (Completely within West Haven City)

A parcel of land in part of the Northwest 1/4 of Section 2, T5N, R2W, Salt Lake Base and Meridian, Weber County, Utah, described as having a POINT OF BEGINNING being S88°58'51"E 1884.69 feet from the West 1/4 corner of said Section 2; thence N43°57'00"W 647.54 feet; thence N46°03'00"E 150.00 feet; thence S43°57'00"E 374.86 feet to a point on the Southeast right-of-way line of Midland Drive; thence N46°03'00"E 550.74 feet along the Southeast right-of-way line of Midland Drive; thence S43°57'00"E 667.51 feet; thence S00°34'06"W 215.90 feet; thence N88°58'51"W 776.50 feet along the E-W 1/4 line of said Section 2 to the Point of Beginning.

Val Surrage

Val Surrage, Manager,
Taylor-West Weber Water Improvement District

4-14-2008

Date

ACKNOWLEDGEMENT

State of Utah)

§

County of Weber)

On this 14 day of April, 2008, before me, Shelley P Hadley, a notary public, personally appeared Val Surrage, proved on the basis of satisfactory evidence to be the person whose name is subscribed to this instrument, and acknowledged he executed the same. Witness my hand and official seal.

Shelley P Hadley
Notary Public

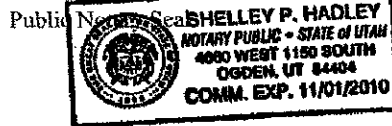

Q:\TWW\WID\Word Docs\Annexation docs\03-26-08 TWW withdrawal of area 20.doc

Received

MAY 01 2008

Gary E. [Signature]
Liaison Director